

SUBJECT TRACT

BOA-22782

20-13 35

15.1

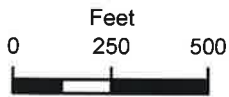

BOARD OF ADJUSTMENT CASE REPORT

STR: 0335

Case Number: **BOA-22782**

CZM: 30

CD: 3

HEARING DATE: 11/12/2019 1:00 PM

APPLICANT: Magdaleno Jaimes

ACTION REQUESTED: Special Exception to permit a carport in the street setback and street yard with modifications to the allowable height, width, length and setback requirements (Section 90.090-C.1)

LOCATION: 6851 E KING PL N

ZONED: RS-3

PRESENT USE: Residential

TRACT SIZE: 7562.05 SQ FT

LEGAL DESCRIPTION: LT 2 BLK 5, VAL-CHARLES ADDN

RELEVANT PREVIOUS ACTIONS:

Subject property: None

Surrounding Properties: None

RELATIONSHIP TO THE COMPREHENSIVE PLAN: The Tulsa Comprehensive Plan identifies the subject property as part of a "Main Street" and an "Area of Growth".

Main Streets are Tulsa's classic linear centers. They are comprised of residential, commercial, and entertainment uses along a transit-rich street usually two to four lanes wide and includes much lower intensity residential neighborhoods situated behind. Main Streets are pedestrian-oriented places with generous sidewalks, storefronts on the ground floor of buildings, and street trees and other amenities. Visitors from outside the surrounding neighborhoods can travel to Main Streets by bike, transit, or car. Parking is provided on street, small private off street lots, or in shared lots or structures.

The purpose of **Areas of Growth** is to direct the allocation of resources and channel growth to where it will be beneficial and can best improve access to jobs, housing, and services with fewer and shorter auto trips. Areas of Growth are parts of the city where general agreement exists that development or redevelopment is beneficial. As steps are taken to plan for, and, in some cases, develop or redevelop these areas, ensuring that existing residents will not be displaced is a high priority. A major goal is to increase economic activity in the area to benefit existing residents and businesses, and where necessary, provide the stimulus to redevelop.

ANALYSIS OF SURROUNDING AREA: The subject tract is an RS-3 zoned property located West of the NW/c of N 71st E. Ave. and E. King Pl.

STAFF COMMENTS: The applicant is requesting a **Special Exception** to permit a carport in the street setback and street yard with modifications to exceed the allowable height, width, length and setback requirements (Section 90.090-C.1)

1. Carports

Carports are allowed in street setbacks and yards in R zoning districts only if approved in accordance with the special exception procedures of Section 70.120. Any carport that occupies all or a portion of the street setback or street yard area must comply with the following regulations, unless otherwise expressly approved by the board of adjustment as part of the special exception process:

- a. A carport may be a detached accessory building or an integral part of the principal building.
- b. The area of a carport may not exceed 20 feet in length by 20 feet in width.
- c. A detached carport may not exceed 8 feet in height at its perimeter or 18 feet in height at its highest point. A carport erected as an integral part of the principal building may not exceed 8 feet in height within 10 feet of a side lot line or 18 feet at its highest point.
- d. The carport structure must be setback from side lot lines by a minimum distance of 5 feet or the depth of the principal building setback, whichever is a greater distance from the side lot line.
- e. The carport structure may project into the required street setback by a maximum distance of 20 feet. This distance must be measured from the required street setback line or the exterior building wall of the principal building, whichever results in the least obstruction of the street setback.
- f. All sides of a carport that are within the required street setback must be open and unobstructed, except for support columns, which may not obstruct more than 15% of the area of any side.
- g. The entire area under a carport may be used only for storage of operable, licensed motor vehicles (i.e., cars, boats, pickup trucks, vans, sport utility vehicles), which are customarily accessory to the dwelling. No other use of the carport area is allowed.

SAMPLE MOTION:

Move to _____ (approve/deny) a **Special Exception** to permit a carport in the street setback and street yard with modifications to exceed the allowable height, width, length and setback requirements (Section 90.090-C.1)

Per the Conceptual Plan(s) shown on page(s) _____ of the agenda packet.

- Subject to the following conditions (including time limitation, if any):

The Board finds that the requested Special Exception will be in harmony with the spirit and intent of the Code and will not be injurious to the neighborhood or otherwise detrimental to the public welfare.



Facing West on King Pl.

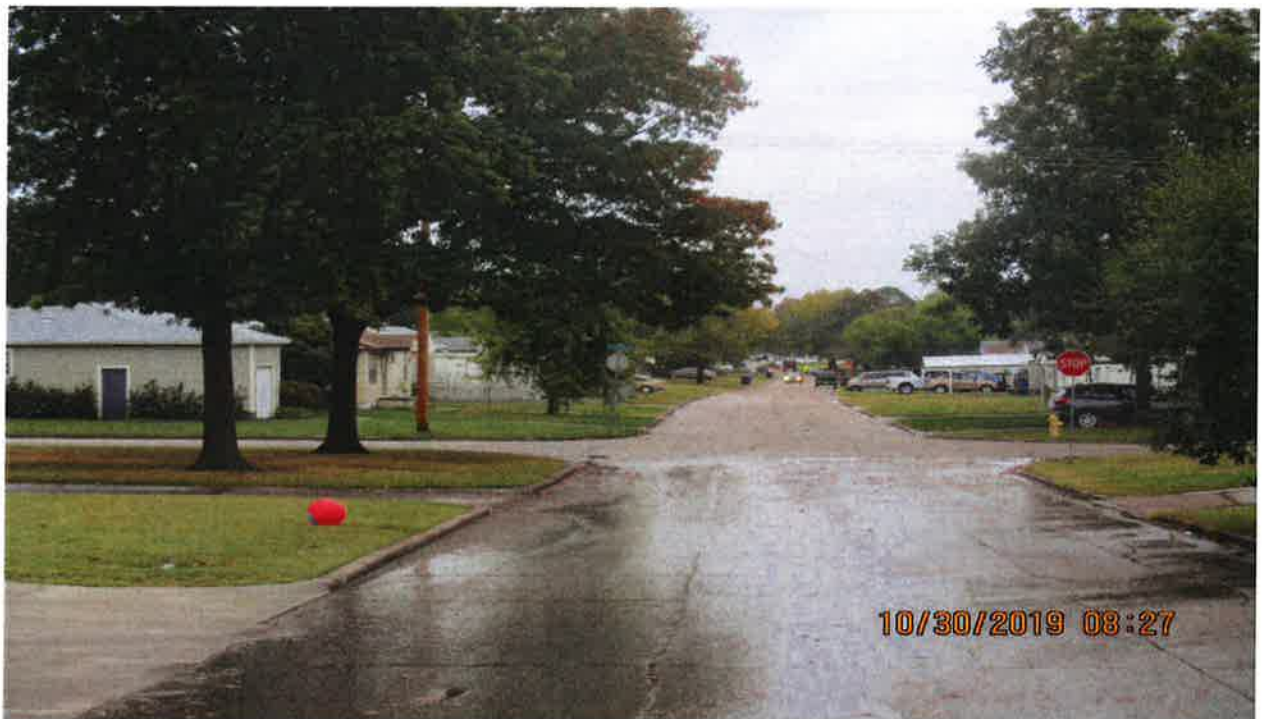

Facing East on King Pl.



Subject Property

LOT
8,679 sq ft

YARD

YARD

53' 6"

11' 6"

35'

46' 6"

HOUSE

1,280.84 sq ft

30' 10"

4' 9"

FRONT
PORCH

24'

CARPORT
552 sq ft

4 POLES,
6" x 6"

23' 6"

23'

WATER
VALVE



18' 6"

YARD

STREET

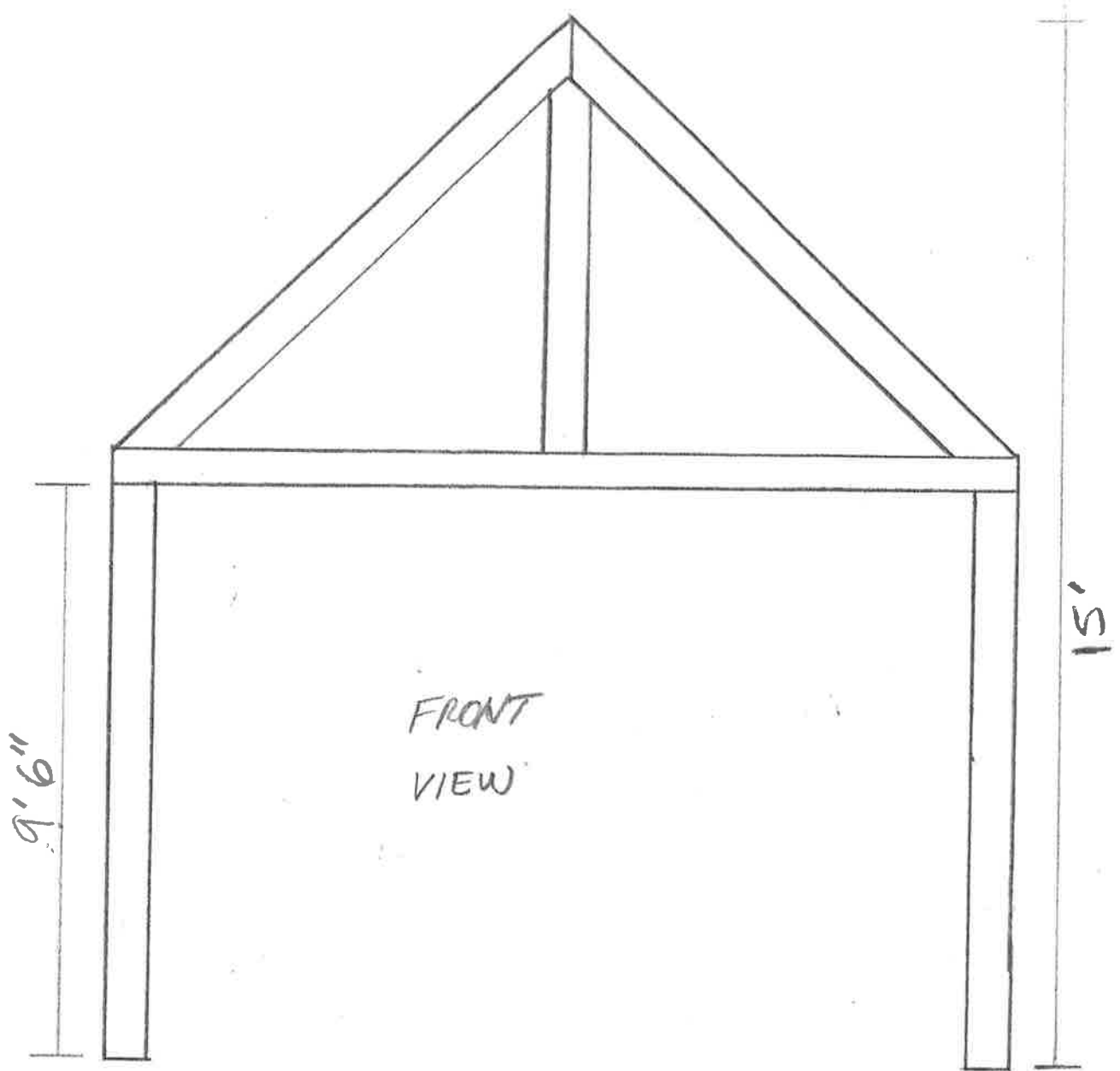

STREET

13.8

Jeff S. Taylor
Zoning Official
Plans Examiner

TEL(918) 596-7637
jstaylor@cityoftulsa.org



DEVELOPMENT SERVICES

175 EAST 2nd STREET, SUITE 450
TULSA, OKLAHOMA 74103

ZONING CLEARANCE PLAN REVIEW

Magdaleno James

3/29/2019

APPLICATION NO: BLDR-24005-2019 (PLEASE REFERENCE THIS NUMBER WHEN CONTACTING OUR OFFICE)

Project Location: 6851 E King Pl

Description: Carport

INFORMATION ABOUT SUBMITTING REVISIONS

OUR REVIEW HAS IDENTIFIED THE FOLLOWING CODE OMISSIONS OR DEFICIENCIES IN THE PROJECT APPLICATION FORMS, DRAWINGS, AND/OR SPECIFICATIONS. THE DOCUMENTS SHALL BE REVISED TO COMPLY WITH THE REFERENCED CODE SECTIONS.

REVISIONS NEED TO INCLUDE THE FOLLOWING:

1. A COPY OF THIS DEFICIENCY LETTER
2. A WRITTEN RESPONSE AS TO HOW EACH REVIEW COMMENT HAS BEEN RESOLVED
3. THE COMPLETED REVISED/ADDITIONAL PLANS FORM (SEE ATTACHED)
4. BOARD OF ADJUSTMENT APPROVAL DOCUMENTS, IF RELEVANT

REVISIONS SHALL BE SUBMITTED DIRECTLY TO THE CITY OF TULSA PERMIT CENTER LOCATED AT

175 EAST 2nd STREET, SUITE 450, TULSA, OKLAHOMA 74103, PHONE (918) 596-9601.

THE CITY OF TULSA WILL ASSESS A RESUBMITTAL FEE. DO NOT SUBMIT REVISIONS TO THE PLANS EXAMINERS.

SUBMITTALS FAXED / EMAILED TO PLANS EXAMINERS WILL NOT BE ACCEPTED.

IMPORTANT INFORMATION

1. SUBMIT TWO (2) SETS [4 SETS IF HEALTH DEPARTMENT REVIEW IS REQUIRED] OF REVISED OR ADDITIONAL PLANS. REVISIONS SHALL BE IDENTIFIED WITH CLOUDS AND REVISION MARKS.
2. INFORMATION ABOUT ZONING CODE, INDIAN NATION COUNCIL OF GOVERNMENT (INCOG), BOARD OF ADJUSTMENT (BOA), AND TULSA METROPOLITAN AREA PLANNING COMMISSION (TMAPC) IS AVAILABLE ONLINE AT WWW.INCOG.ORG OR AT INCOG OFFICES AT 2 W. 2nd ST., 8th FLOOR, TULSA, OK, 74103, PHONE (918) 584-7526.
3. A COPY OF A "RECORD SEARCH" ☐ **IS** ☒ **IS NOT** INCLUDED WITH THIS LETTER. PLEASE PRESENT THE "RECORD SEARCH" ALONG WITH THIS LETTER TO INCOG STAFF AT TIME OF APPLYING FOR BOARD OF ADJUSTMENT ACTION AT INCOG. UPON APPROVAL BY THE BOARD OF ADJUSTMENT, INCOG STAFF WILL PROVIDE THE APPROVAL DOCUMENTS TO YOU FOR IMMEDIATE SUBMITTAL TO OUR OFFICE. (See revisions submittal procedure above.).

(continued)

REVIEW COMMENTS

SECTIONS REFERENCED BELOW ARE FROM THE CITY OF TULSA ZONING CODE TITLE 42 AND CAN BE VIEWED AT WWW.CITYOFTULSA-BOA.ORG

Application No. **BLDR-000000-2019**

Note: As provided for in Section 70.130 you may request the Board of Adjustment to grant a variance from the terms of the Zoning Code requirements identified in the letter of deficiency below. Please direct all questions concerning variances, special exceptions, appeals of an administrative official decision, Master Plan Developments Districts (MPD), Planned Unit Developments (PUD), Corridor (CO) zoned districts, zoning changes, platting, lot splits, lot combinations, alternative compliance landscape and screening plans and all questions regarding (BOA) or (TMAPC) application forms and fees to an INCOG representative at 584-7526. It is your responsibility to submit to our offices documentation of any appeal decisions by an authorized decision making body affecting the status of your application so we may continue to process your application. INCOG does not act as your legal or responsible agent in submitting documents to the City of Tulsa on your behalf. Staff review comments may sometimes identify compliance methods as provided in the Tulsa Zoning Code. The permit applicant is responsible for exploring all or any options available to address the noncompliance and submit the selected compliance option for review. Staff review makes neither representation nor recommendation as to any optimal method of code solution for the project.

Special exception approval required; see §90.090-C1.

1. Sec.90.090-C.1 Carports: Carports are allowed in street setbacks and yards in R zoning districts only if approved in accordance with the special exception procedures of Section 70.120. Any carport that occupies all or a portion of the street setback or street yard area must comply with the following regulations, unless otherwise expressly approved by the board of adjustment as part of the special exception process:

- a. A carport may be a detached accessory building or an integral part of the principal building.
- b. The area of a carport may not exceed 20 feet in length by 20 feet in width.
- c. A detached carport may not exceed 8 feet in height at its perimeter or 18 feet in height at its highest point. A carport erected as an integral part of the principal building may not exceed 8 feet in height within 10 feet of a side lot line or 18 feet at its highest point.
- d. The carport structure must be setback from side lot lines by a minimum distance of 5 feet or the depth of the principal building setback, whichever is a greater distance from the side lot line.
- e. The carport structure may project into the required street setback by a maximum distance of 20 feet. This distance must be measured from the required street setback line or the exterior building wall of the principal building, whichever results in the least obstruction of the street setback.
- f. All sides of a carport that are within the required street setback must be open and unobstructed, except for support columns, which may not obstruct more than 15% of the area of any side.
- g. The entire area under a carport may be used only for storage of operable, licensed motor vehicles (i.e., cars, boats, pickup trucks, vans, sport utility vehicles), which are customarily accessory to the dwelling. No other use of the carport area is allowed

Review comment: The proposed carport is located in the street setback area and requires special exception granted by the BOA. Please contact an INCOG representative at 918-584-7526 for further assistance. Please note: the regulations underlined above must be addressed as part of the special exception process as the proposed structure is not in compliance with said regulations as submitted. If approved, submit a copy of the approved special exception as a revision to your application.

This letter of deficiencies covers Zoning plan review items only. You may receive additional letters from other disciplines such as Building or Water/Sewer/Drainage for items not addressed in this letter. A hard copy of this letter is available upon request by the applicant.

Please Notify Plans Examiner By Email When You Have Submitted A Revision. If you originally submit paper plans, revisions must be submitted as paper plans. If you submit online, revisions must be submitted online.

END –ZONING CODE REVIEW

NOTE: THIS CONSTITUTES A PLAN REVIEW TO DATE IN RESPONSE TO THE SUBMITTED INFORMATION ASSOCIATED WITH THE ABOVE REFERENCED APPLICATION. ADDITIONAL ISSUES MAY DEVELOP WHEN THE REVIEW CONTINUES UPON RECEIPT OF ADDITIONAL INFORMATION REQUESTED IN THIS LETTER OR UPON ADDITIONAL SUBMITTAL FROM THE APPLICANT.

KEEP OUR OFFICE ADVISED OF ANY ACTION BY THE CITY OF TULSA BOARD OF ADJUSTMENT OR TULSA METROPOLITAN AREA PLANNING COMMISSION AFFECTING THE STATUS OF YOUR APPLICATION FOR A ZONING CLEARANCE PERMIT.



0 250 500
Feet



Subject
Tract

BOA-22782

20-13 35

Note: Graphic overlays may not precisely
align with physical features on the ground.

Aerial Photo Date: February 2018



15.12



E LATIMER PL

N 71st AVE

E KING PL

E KING ST

0 50 100
Feet



Subject
Tract

BOA-22782

20-13 35

Note: Graphic overlays may not precisely
align with physical features on the ground.

Aerial Photo Date: February 2018



15.13

**THIS PAGE
INTENTIONALLY
LEFT BLANK**